



Law School – Law 2025-27 Capital Plan Request

Campus Planning Committee Meeting
November 30, 2023

Bethany Pluymers, Associate Dean of Administration

Victoria Coulter, Associate Director of the Law Library, Collections & Administration/Facility Director



Law School Overview

- Law School enrollment and revenue steadily grew from 2018-2022.
- Oldest part of the building dates back to 1939.
- Last major upgrade was in 1996.
- We have refurbished existing spaces to the extent possible, but the building needs a major upgrade.



Law School Welcome Terrace & Leadership Suite – 2025-27 Biennium

Per the 2015 Campus Plan:

- A new Welcome Terrace and Leadership Suite would integrate nature with instruction and administration.
- This new green space and courtyard would tie the main campus to the urban south campus.
- Update facilities to be more flexible for programming where classes and meetings could take place on the terrace
- We have approved a Master Plan and Pre-Design to assess potential growth, identify opportunities for modernizing and increasing efficiencies in the current facilities and explore options for creating outdoor space for student use.



Law School Welcome Terrace & Leadership Suite – 2025-27 Biennium

Project Need

Create efficient faculty workspace to encourage collaboration

Improve vertical building circulation and access to 5th floor and other areas

Provide additional quality student engagement space.

Strategic Priorities and Planning Principles

Supports 2015 Campus Mater Plan (revitalizing outdoor spaces).

Renovates Existing Space to be More Adaptable (increase accessibility).

Reuses and Renovates Existing Facility (increase efficiency).

Gift/Grant Funded project, budget estimated to be \$4.9M

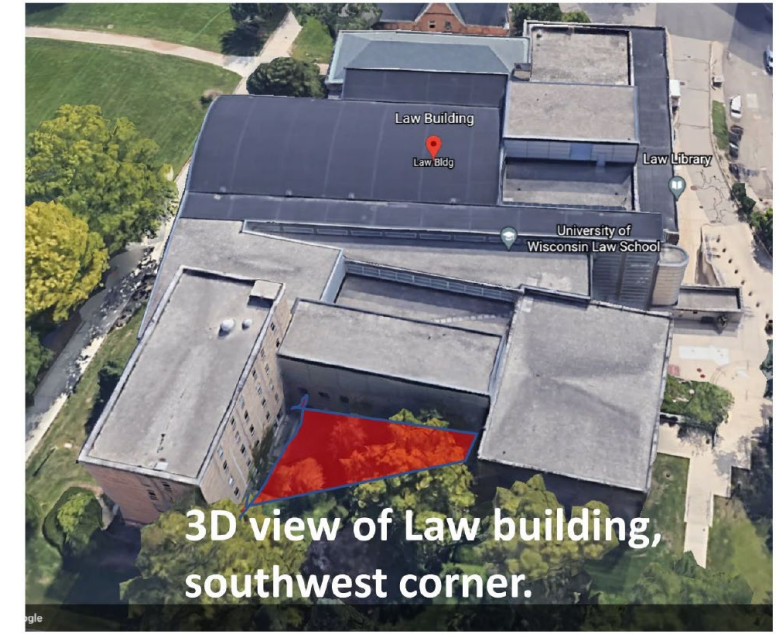



Law School Welcome Terrace & Leadership Suite– 2025-27 Biennium

The current administrative suite is disjointed and remote with long, narrow passages.



The Dean's Suite: closed off from students and other administrators and doesn't invite collaboration.

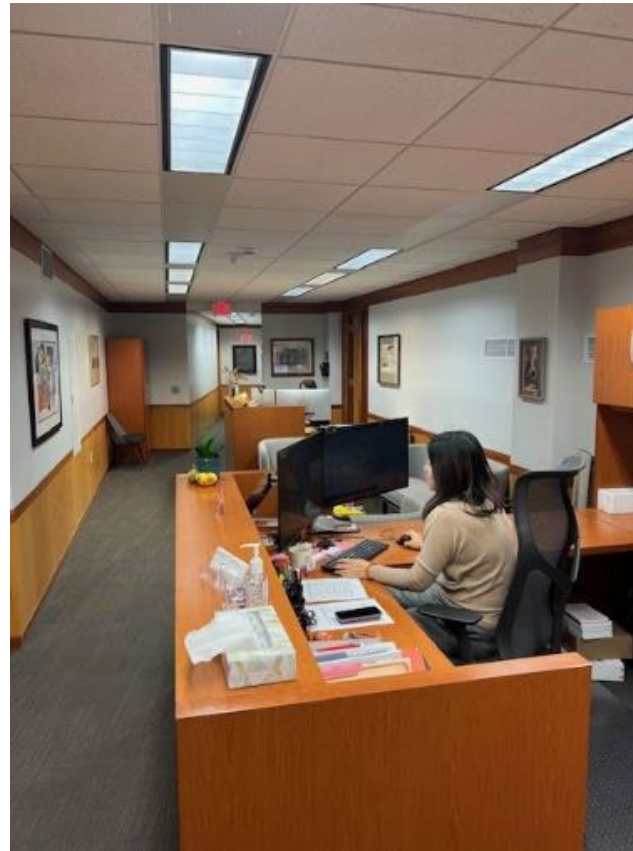

Exterior study limits shown as red shaded area.
Interior study limits shown as yellow shaded area.

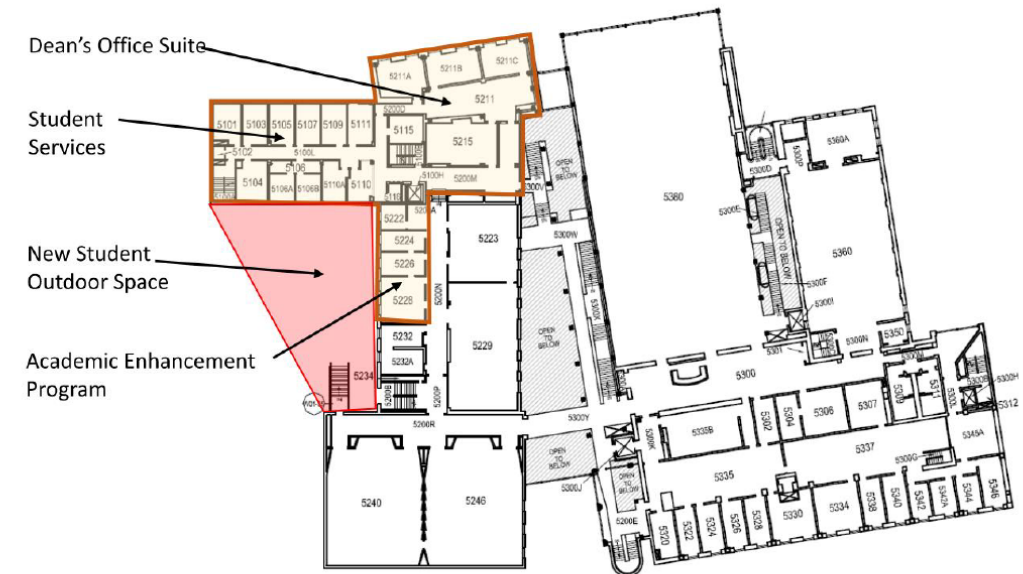

Law Building Existing 5th Floor Plan - NTS

Law School Welcome Terrace & Leadership Suite – 2025-27 Biennium

The Dean's Conference Room, the site of many important meetings – including with dignitaries and alumni – lacks natural light.



Law School Welcome Terrace & Leadership Suite – 2025-27 Biennium



Our Information & Reception Desk and Staff Lounge aren't especially welcoming, but . . .



Law School Welcome Terrace & Leadership Suite – 2025-27 Biennium



- They look out onto a gorgeous area right off Bascom Hill with a green space and sunset view that are currently underutilized.



Law School Welcome Terrace & Leadership Suite– 2025-27 Biennium



- **Our vision:** To create a new Welcome Terrace and Administrative Suite, open to green space and natural light, for students, staff, faculty, and alumni.



Law School Welcome Terrace & Leadership Suite – 2025-27 Biennium

As mentioned in the campus master plan, “This spectacular lakefront setting is its greatest physical asset. The natural areas, historic landscapes, and public spaces are the places that create astounding first impressions and lasting memories for those who visit, work, educate, and learn at this institution.” With that in mind, we envision a patio like Education Building in our green space, incorporating mature trees already there into the space.



Law School Welcome Terrace & Leadership Suite– 2025-27 Biennium



— And a Dean Suite in a round like the Business School...





Connecting Strategic Plan to a Facilities Plan

1. Pre-design study.
2. Identify Opportunities for modernizing and increasing efficiencies in the current facility.
3. Explore options for creating outdoor space for everyone's use.
4. Review and get approval from State Historic Preservation office.
5. Find a donor.
6. Create a high performing leadership suite, inviting to students and prospective faculty.
7. Capitalize on extensive green space behind the building, making it more useful to all for collaboration and teaching.
8. From our own strategic plan, this would improve the Law School building and infrastructure, focusing on functions that are essential to our students.

Major Project Priorities 2025-27

1. Major Project Priority #1

- 4,000 GSF size of project
- Budget \$4.9M

QUESTIONS?