



School of Education – SoE

2025–27 Capital Plan Request

Campus Planning Committee Meeting
November 16, 2023

Kinesiology Building

Diana Hess, Dean, School of Education



Image: HGA project study





Department of Kinesiology Academic Programs

3

undergraduate
degrees

Health Promotion and Health Equity, BS
Kinesiology, BS
Physical Education, BS

4

graduate
degrees

Athletic Training, MS
Kinesiology, MS
Kinesiology, PhD
Occupational Therapy, Doctorate

Kinesiology Enrollment & Projections Undergraduate and Graduate

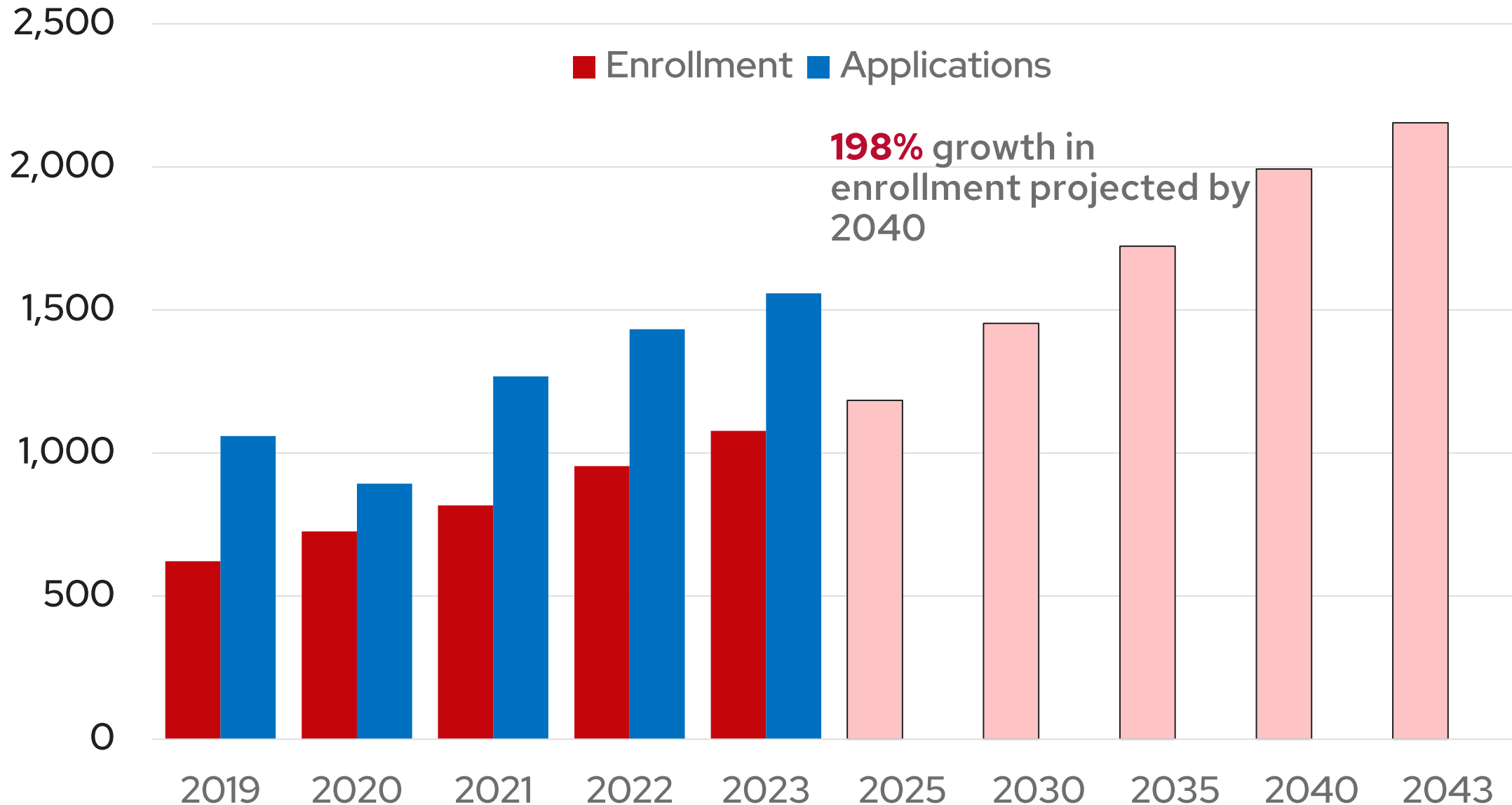

Kinesiology: Credits Follow the Instructor

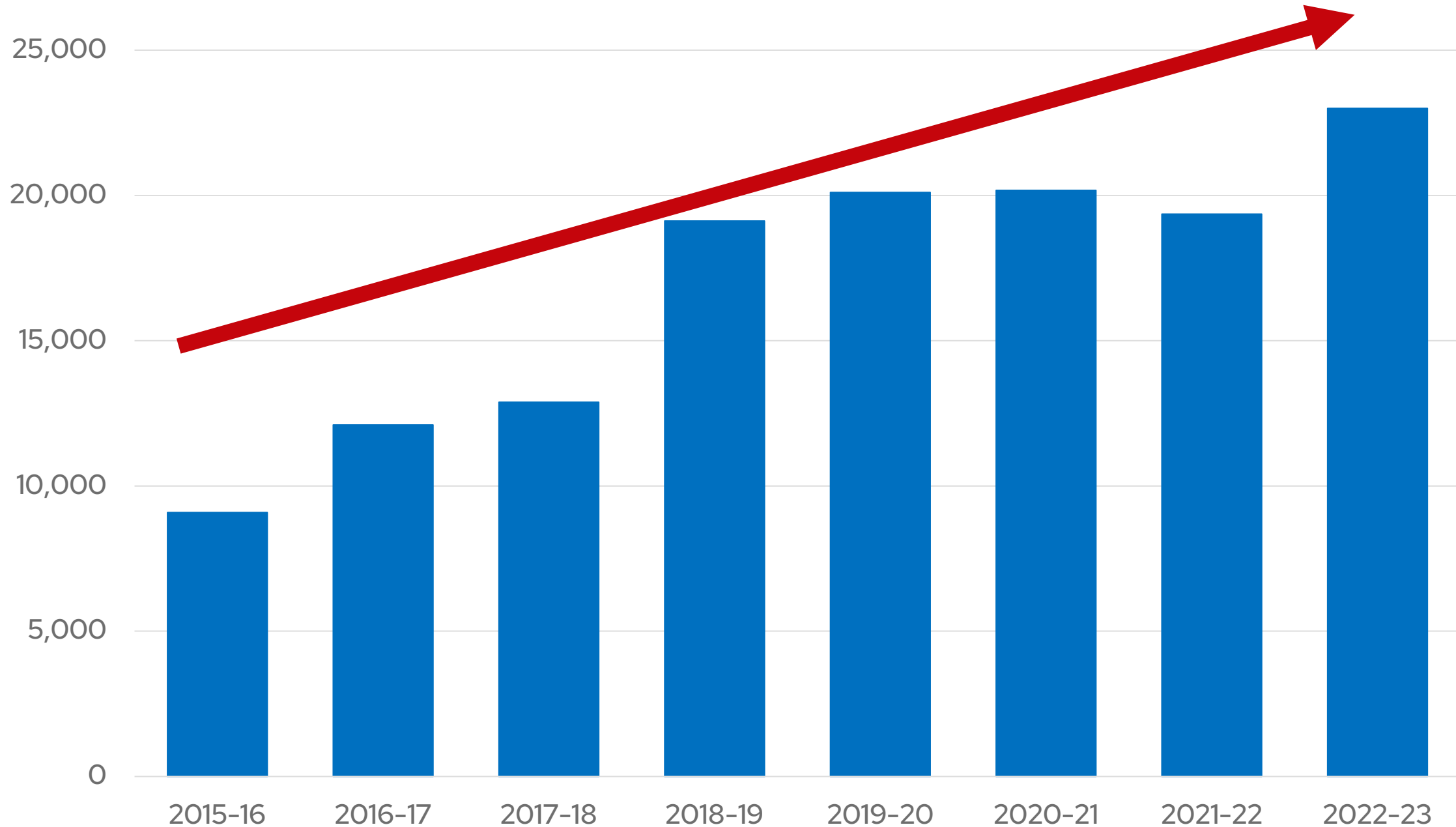

Current Status in Medical Sciences

Below: Undergraduate Anatomy and Physiology courses are taught in small spaces in the lower level of Medical Sciences



Above: An activity-based course taught in Medical Sciences amid building columns

New Kinesiology Building

- Restores space lost in the move to Medical Sciences
- Allows for projected growth in the future
- Makes facilities accessible and centralized for community partners and clientele



Images: HGA project study

New Kinesiology Building

- Houses labs – to support work with participants as well as biological research
- Creates active instructional and multi-purpose spaces
- Modular designs allow for spaces to evolve to meet departmental needs





New Kinesiology Building: Costs and Path Forward

- \$184 million – estimated cost
- Biennium for enumeration: 2025-27
- Funding sources:
General Fund Supported
Borrowing (GFSB) + Gifts and
Grant Funding

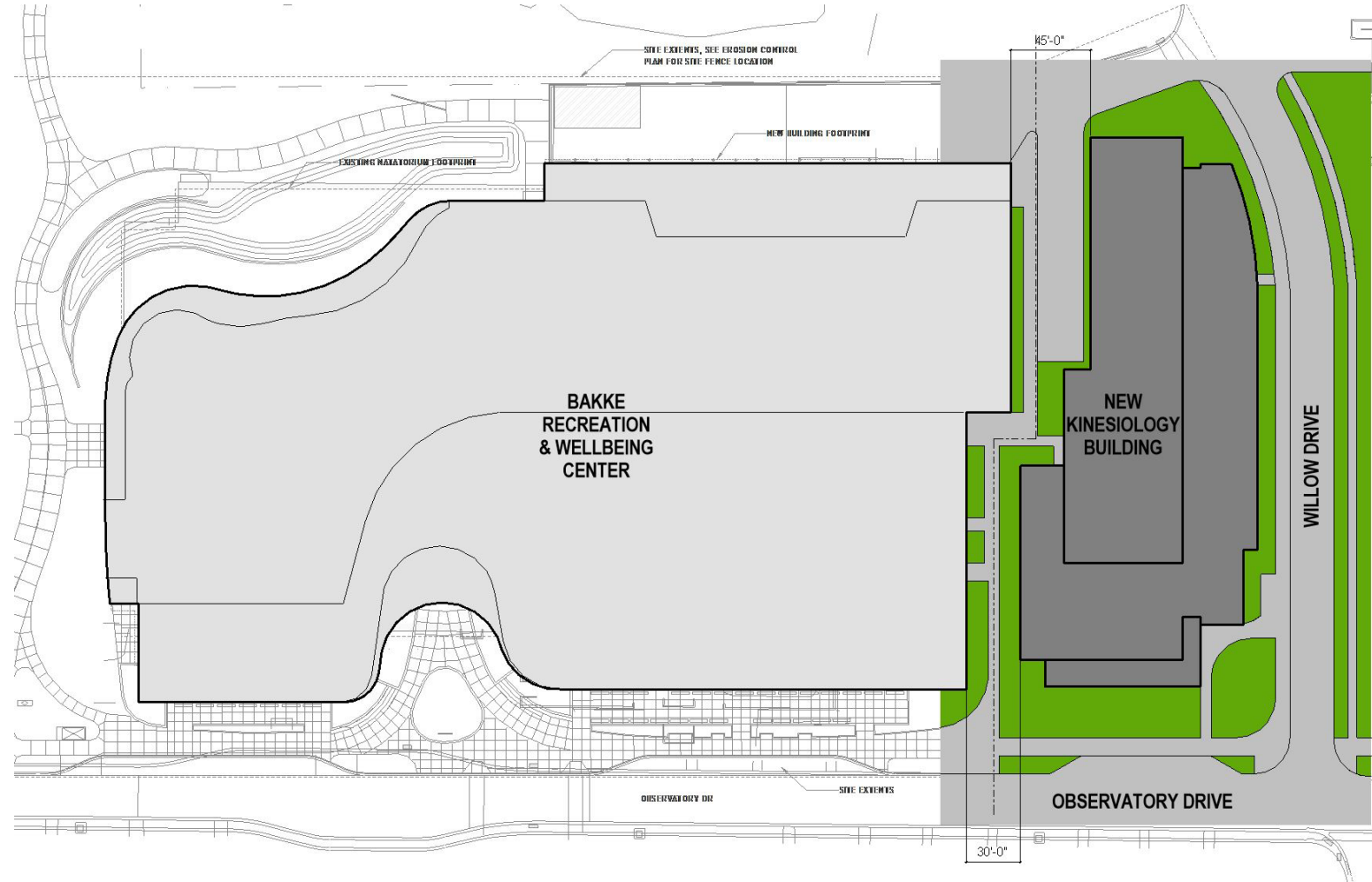

Image: HGA project study



Connecting Strategic Plan to a Facilities Plan

School of Education Strategic Objectives

- Increase Research Portfolio
- Kinesiology is major contributor
- Intentionally Grow and Diversify Enrollment
- Increase undergraduate enrollment in target majors (one is Kinesiology)
- Implement Impact 2030
- A program that strengthens the School of Education by its centenary in 2030 through faculty support, scholarships, and high-impact educational experiences (FIGs, study abroad, paid internships): inclusive of supporting Kinesiology

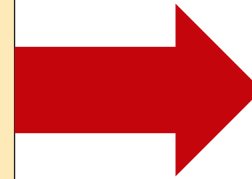

Major Project Priorities 2025-27

New Kinesiology Building

- 157,787 GSF
- \$184M

QUESTIONS?